

23. Notification of Proposed Uses

Lone Star Industries, Inc. is the owner of all land within the mining and reclamation plan with the exception of Parcel 946-1848-3-1 which is owned by Romarita Simoni and Thelma Garin. In order to incorporate Parcel 946-1848-3-1 into Lake B, some provisions will have to be made with the land owner. It will be approximately 20 years before further mining activities are carried out on the property.

25. Sequencing of Mining and Reclamation

The proposed sequencing of mining and reclamation is illustrated in the attached drawings. The end state of reclamation is shown on Sheet 8 of 12-Final Reclamation Plan. Silt ponds will be brought back to the maximum elevations possible from the amount of silt and other material available to fill it.

- a. Backfilling and grading will be accomplished mainly by the retention of silts in the silt ponds. Any necessary grading will be done by graders, dozers and compactors.
- b. Final slopes will be stabilized by regrowth of natural grasses and shrubs.
- c. Silt ponds will eventually stabilize through consolidation. Regrowth of natural occurring vegetation will commence prior to the abandonment of the silt ponds.
- d. Runoff within the proposed silt pond area will be directed to one silt pond. The remaining areas are lakes and creek basins.
- e. Upon completion of mining operations, all equipment and the gravel plant will be removed from the site. Batch plants, asphalt plants, maintenance buildings and other industries will be removed when their respective operations cease.
- f. All of the mined areas adjacent to the chain of lakes will be below the water surface elevation.

- g. Prior to completion of Stage IC, a detailed plan for the incorporation of Lake A and Lake B with the Arroyo Del Valle, as developed in the Specific Plan, will be submitted for County approval.
- h. There are no residual hazards to be removed.
- i. The silt pond areas are intended to be brought back into farming or grazing use as soon as possible. Building on these farm sites will commence when feasible.

27. Reclamation and Affect on Future Mining

Additional sand and gravel resources will be covered by silts and other material making the recovery of the remaining resources difficult or unfeasible in the future.

The mining of adjoining properties will be affected by the high levels of impounded water in the very permeable strata at these sites.

RECLAMATION PLAN

LONE STAR INDUSTRIES, INC.

PLEASANTON, CALIFORNIA

INDEX

SHEET NO.	DESCRIPTION
1	TITLE SHEET
2	PERMIT BOUNDARIES
3	STAGE IA - 1986 to 1990
4	STAGE IB - 1991 to 1995
5	STAGE IC - 1996 to 2015
6	STAGE II - 2006 to 2030 - OPTION NO 1
7	STAGE II - 2006 to 2030 - OPTION NO 2
8	FINAL RECLAMATION PLAN
9	CROSS SECTION
10	800 CFS TURNOUT
11	LAKE 'B' TO LAKE 'C' CONDUIT
12	LAKE 'B' EROSION PROTECTION

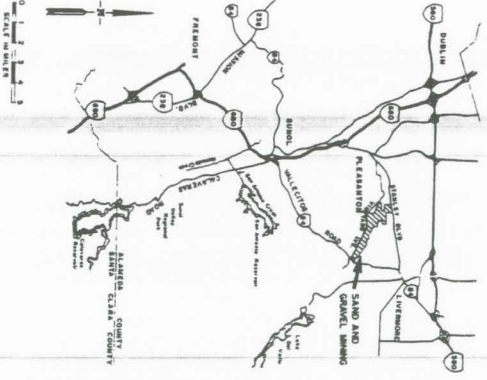

BY *W.M. Calvert* DATE 8/13/96
 W.M. CALVERT
 REGISTERED CIVIL ENGINEER NO. 13748



NO.	DATE	BY	REVISION
1	8/13/96	W.M. Calvert	ISSUED FOR PERMIT

TITLE SHEET
LONE STAR INDUSTRIES, INC.

BISSELL & KARN, INC.
 CIVIL ENGINEERS
 2311 MERCED ST., SAN LEANDRO, CALIF. 94677
 (415) 483-3170

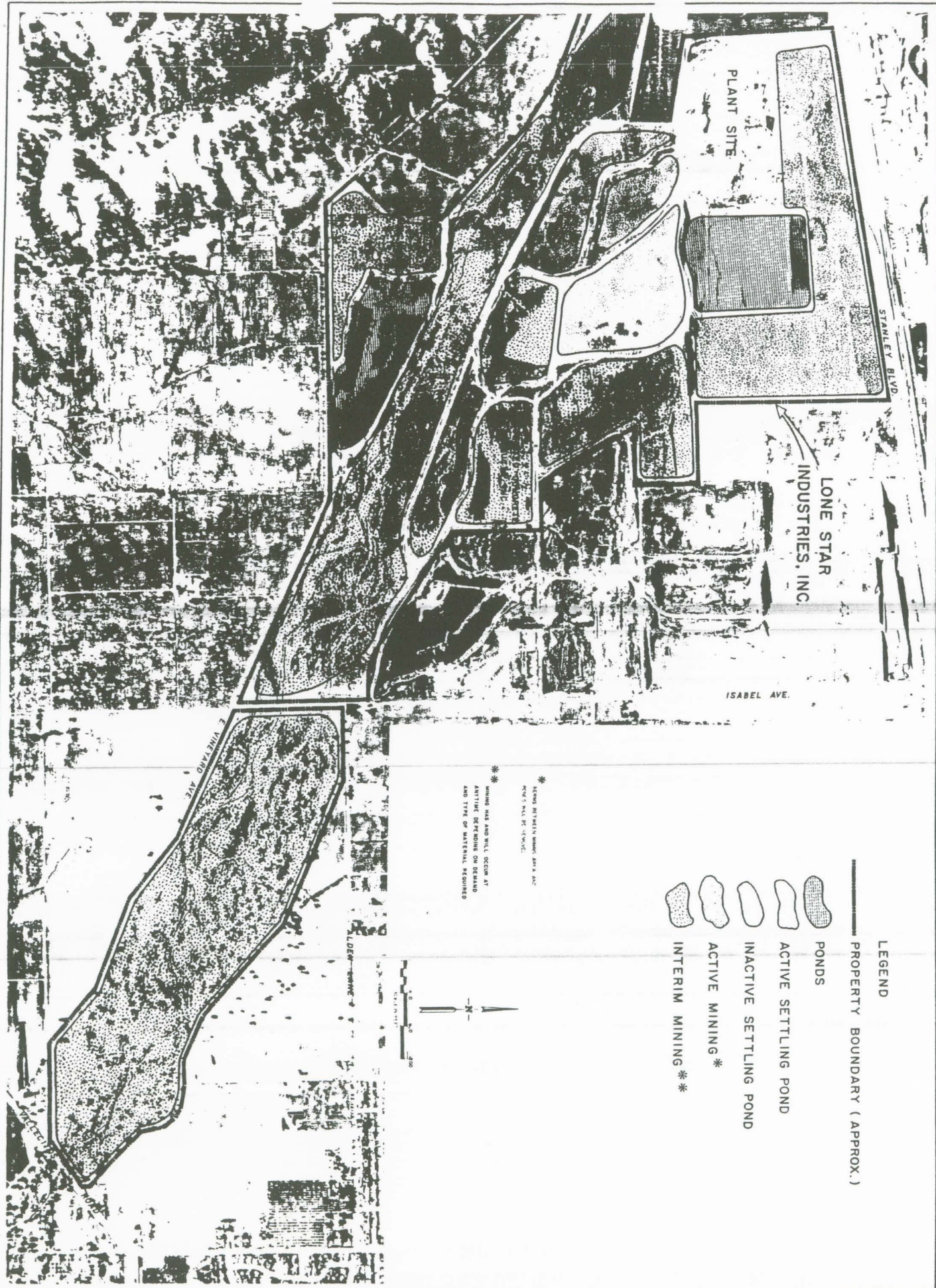





PLANT SITE

LONE STAR INDUSTRIES, INC.

ISABEL AVE.

LEGEND

PROPERTY BOUNDARY (APPROX.)

-  PONDS
-  ACTIVE SETTLING POND
-  INACTIVE SETTLING POND
-  ACTIVE MINING *
-  INTERIM MINING **

* MINING HAS AND WILL OCCUR AT ACTIVE DEPENDING ON DEMAND AND TYPE OF MATERIAL REQUIRED

** MINING INTERIM MINING; DEMAND NOT YET WELL ESTABLISHED

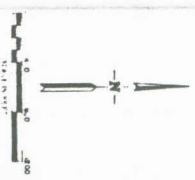

STAGE 1A-1986 to 1990
 LONE STAR INDUSTRIES, INC.
 RECLAMATION PLAN

BK BISSELL & KARN, INC.
 CIVIL ENGINEERS
 2551 MERCED ST. SAN LEANDRO, CALIF. 94577
 (415) 882-2170

DATE	BY	REVISION
11/15/86	JK	1.0
12/15/86	JK	2.0
01/15/87	JK	3.0
02/15/87	JK	4.0
03/15/87	JK	5.0
04/15/87	JK	6.0
05/15/87	JK	7.0
06/15/87	JK	8.0
07/15/87	JK	9.0
08/15/87	JK	10.0
09/15/87	JK	11.0
10/15/87	JK	12.0

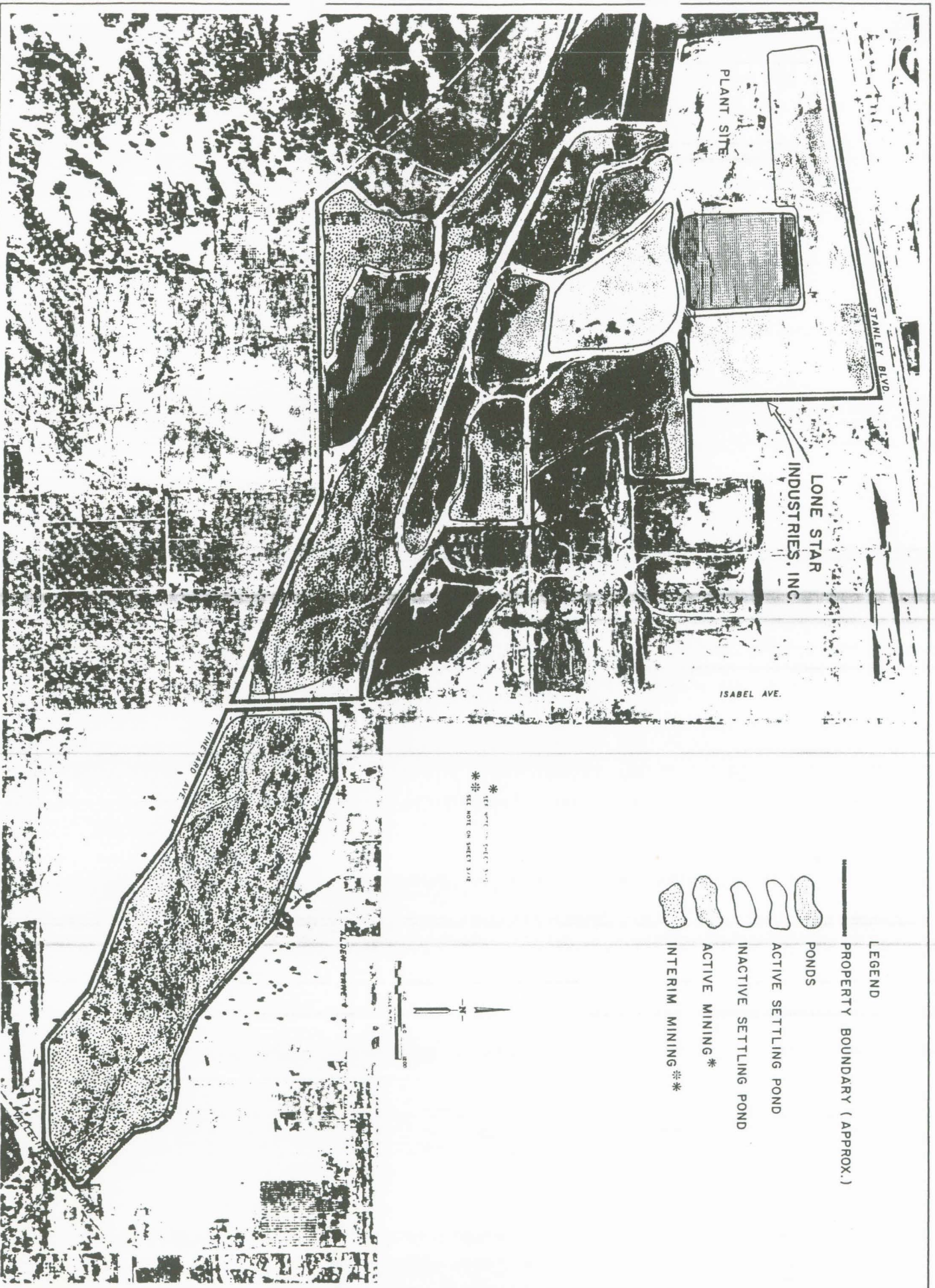

LONE STAR INDUSTRIES, INC.

PLANT SITE

STANLEY BLVD.

ISABEL AVE.

VINELAND AVE.

LEGEND

PROPERTY BOUNDARY (APPROX.)

PONDS

ACTIVE SETTLING POND

INACTIVE SETTLING POND

ACTIVE MINING *

INTERIM MINING **

* SEE NOTE ON SHEET 3108
 ** SEE NOTE ON SHEET 3108



DATE	NO.	SHEET NO.	REV.
12/15/91	001	4	1
12/15/91	002		1
12/15/91	003		1
12/15/91	004		1
12/15/91	005		1
12/15/91	006		1
12/15/91	007		1
12/15/91	008		1
12/15/91	009		1
12/15/91	010		1

STAGE IB-1991 to 1995
 LONE STAR INDUSTRIES, INC.
 RECLAMATION PLAN



BISSELL & KARN, INC.
 CIVIL ENGINEERS
 5551 MERCEN ST., SAN FRANCISCO, CALIF. 94577
 (415) 481-2100

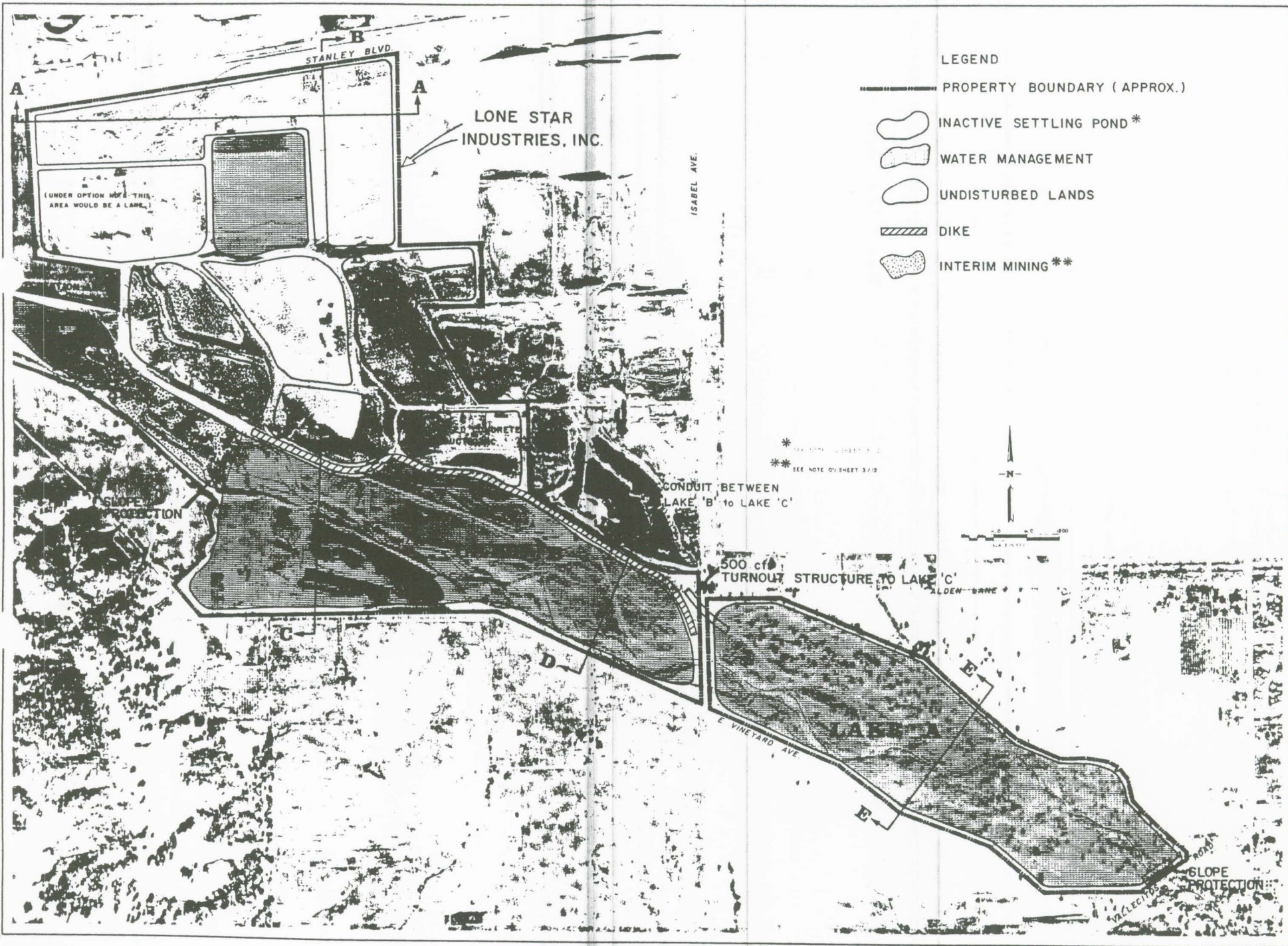

LEGEND

- PROPERTY BOUNDARY (APPROX.)
- INACTIVE SETTLING POND *
- WATER MANAGEMENT
- UNDISTURBED LANDS
- ▨ DIKE
- INTERIM MINING **

* SEE NOTE ON SHEET 1/12
 ** SEE NOTE ON SHEET 3/12

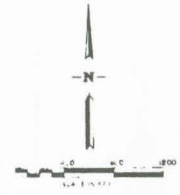

BISSELL & KARN, INC.
 CIVIL ENGINEERS
 1501 W. 15th Street, Dallas, Texas 75210
 TEL: 754-2211



FINAL RECLAMATION PLAN
 LONE STAR INDUSTRIES, INC.

DATE: 12/15/88
 DRAWN BY: J. W. BISSSELL
 CHECKED BY: J. W. BISSSELL
 SCALE: AS SHOWN

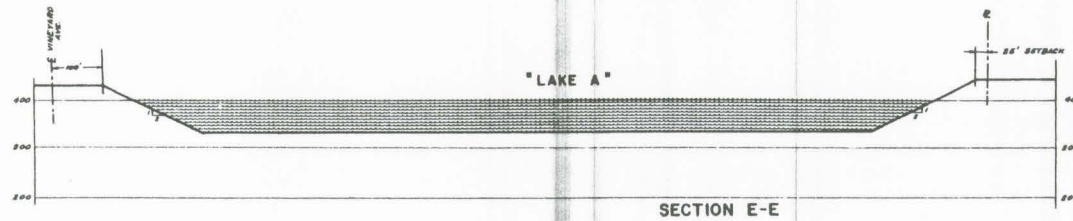
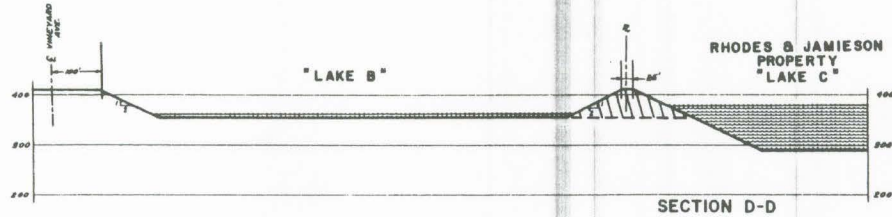
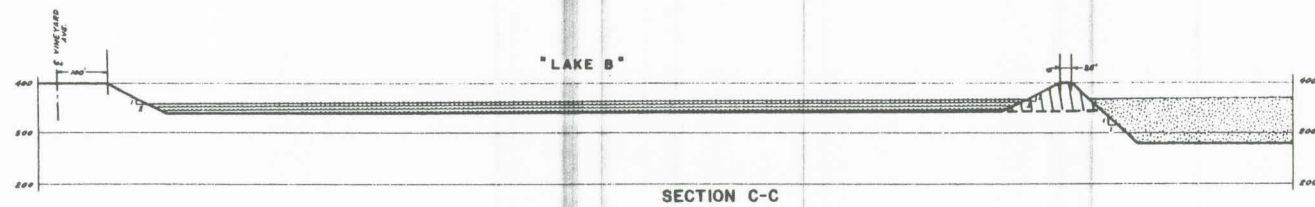
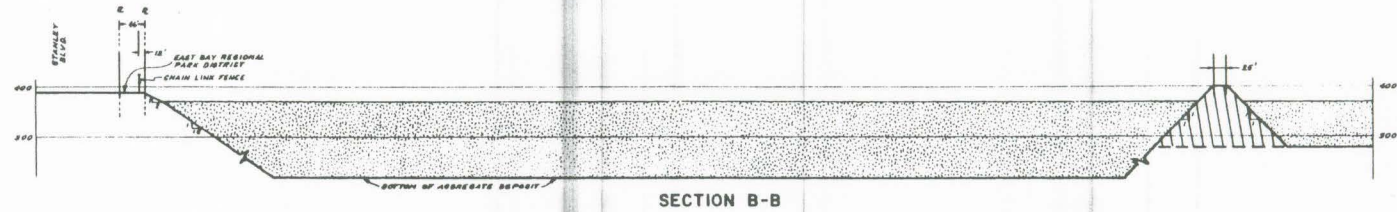
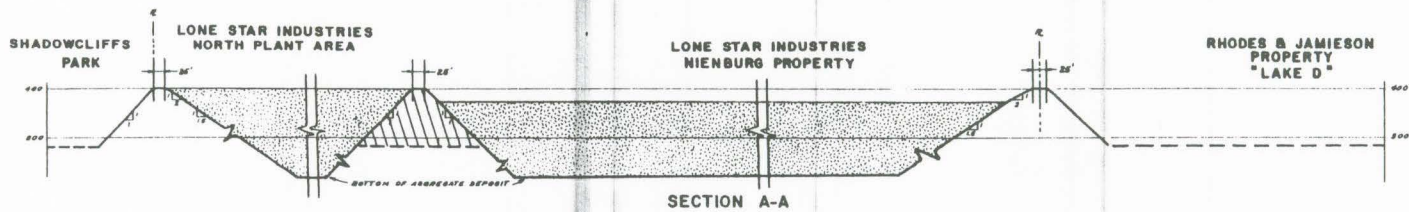

- LEGEND**
- SETTLING POND
 - FILL
 - WATER

NOTES:
 FINAL SETTLING POND ELEVATIONS WILL VARY DEPENDING ON AVAILABILITY OF SILT AND MINING METHODS



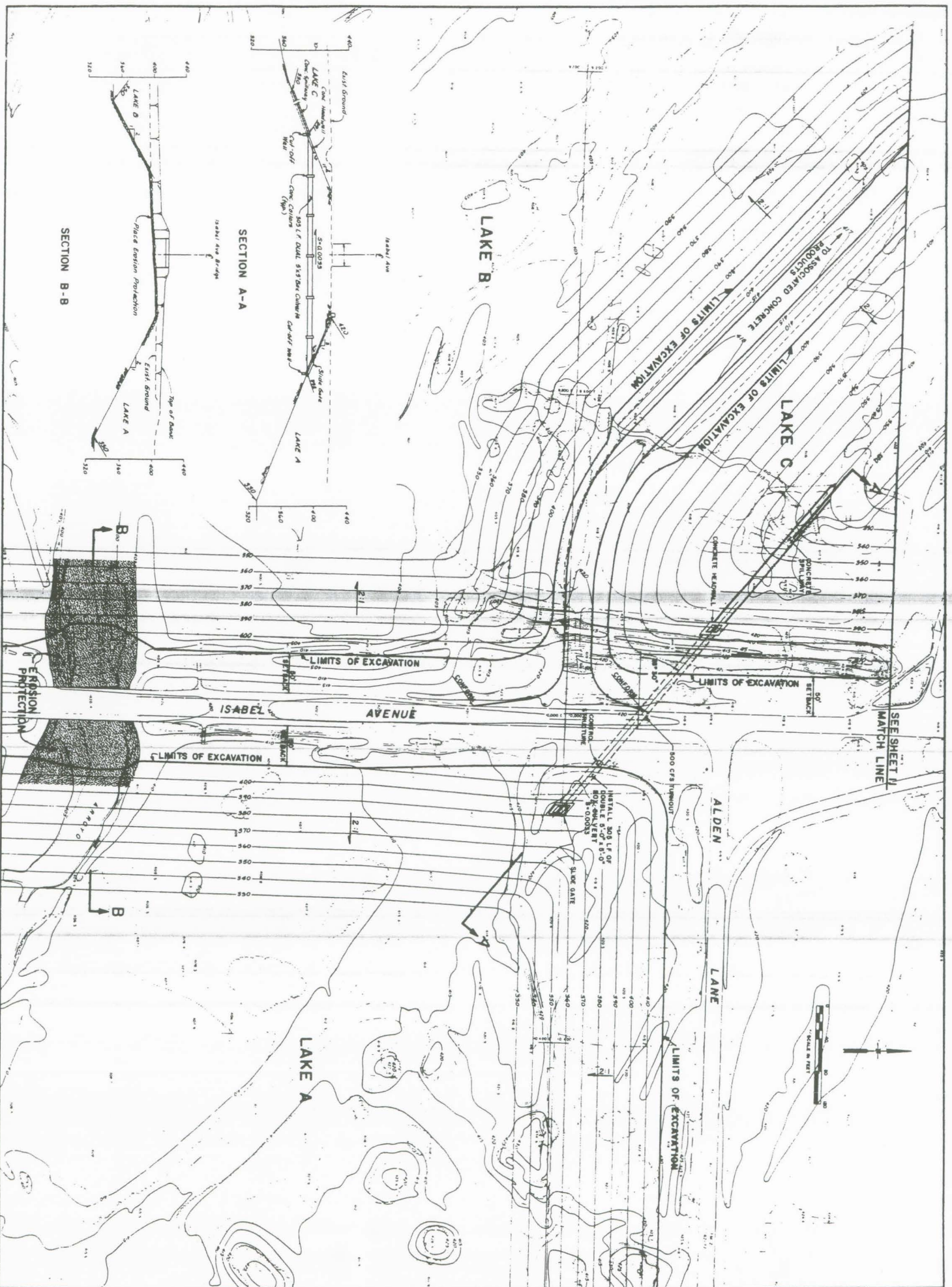

DATE	NO.	SHEET	REVISED	BY	IN CH.	SCALE
10						AS SHOWN
						1" = 20'

**500 CFS TURNOUT
LONE STAR INDUSTRIES, INC.
RECLAMATION PLANS**

	BISSELL & KARN, INC.
	CIVIL ENGINEERS
	2821 MERCED ST., SAN LEANDRO CALIF. 94577
	(415) 482-2174

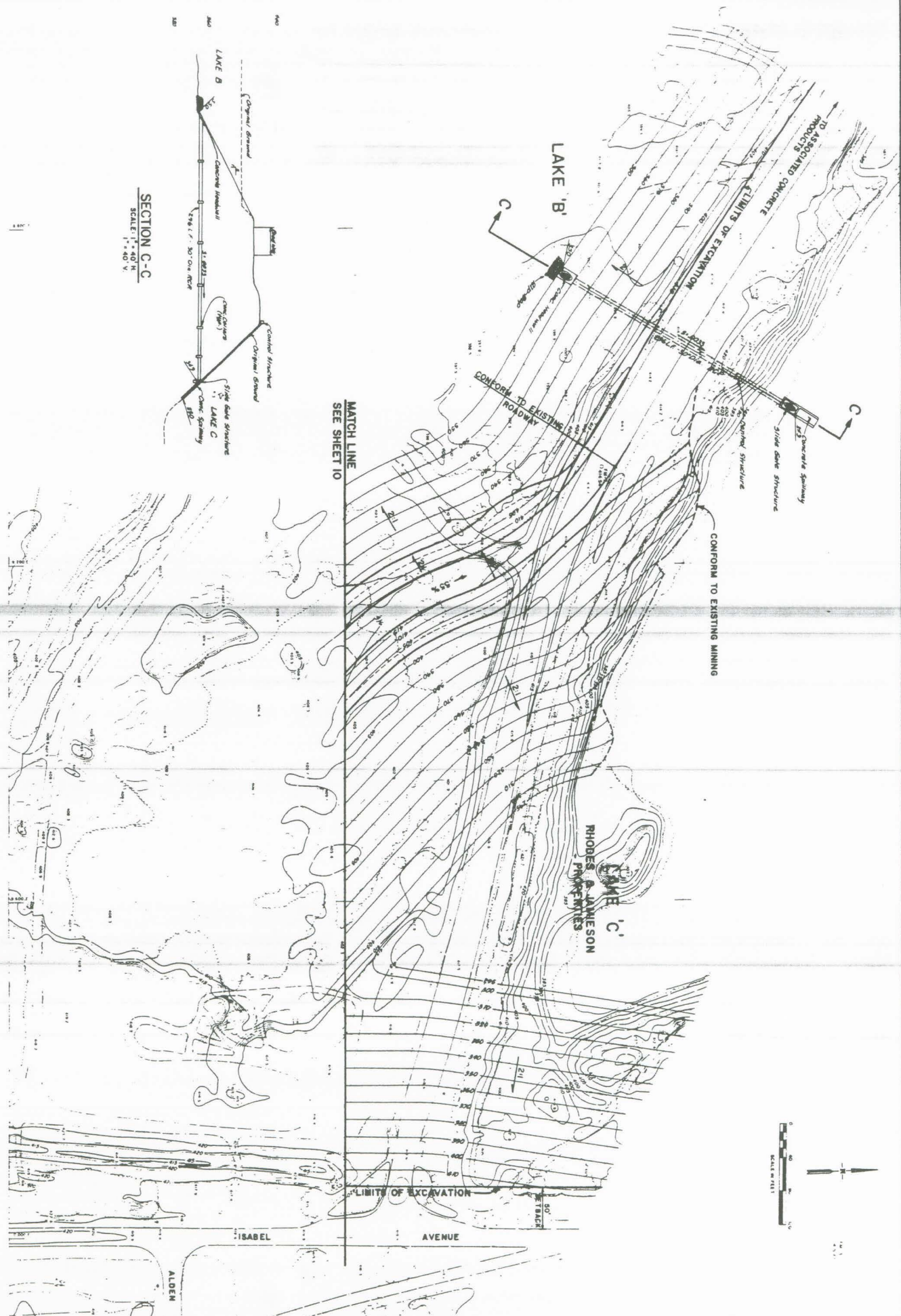

SECTION C-C
SCALE 1" = 40' H.
1" = 40' V.

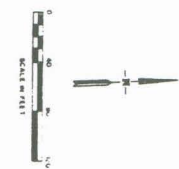
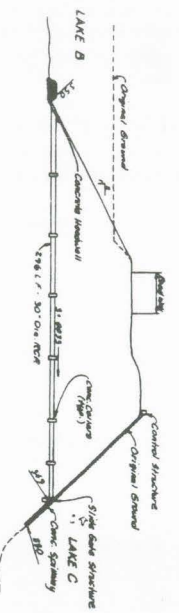

NO.	DATE	BY	SHEET REVISIONS	BY	SCALE
1	11/11/78				1" = 40' H. 1" = 40' V.
2					
3					
4					
5					
6					
7					
8					
9					
10					

LAKE 'B' TO LAKE 'C' CONDUIT
LONE STAR INDUSTRIES, INC.
RECLAMATION PLANS

BR BISSELL & KARN, INC.
CIVIL ENGINEERS
8851 MERLETTA, SAN RAMON, CALIF. 94583
(415) 483-2770

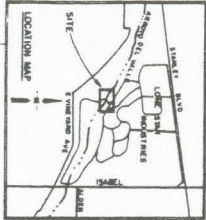

APPROX.
BOUNDARY LIMITS

ARROYO
DEL
VALLE

PLAN OF
EXCAVATION

D

EROSION
PROTECTION

D

LAKE
B

SECTION D-D
SCALE 1"=20'



LIMIT OF EXCAVATION

12	11	10	9	8	7	6	5	4	3	2	1
12	11	10	9	8	7	6	5	4	3	2	1

LAKE 'B' EROSION PROTECTION
LONE STAR INDUSTRIES, INC.
RECONSTRUCTION PLANS



BISELL & KARN, INC.
CIVIL ENGINEERS
2821 MARCO 51, SAN LEANDRO, CALIF. 94767