



3140 PEACEKEEPER WAY
SUITE 102
MCCLELLAN, CA 95652
TEL: 916.825.4997
WWW.COMPASSLAND.NET

February 4, 2019

Mr. Doug Jamieson
CEO
Pleasanton Gravel Company
501 El Charro Road
Pleasanton, California 94588

Mr. Kevin Torell
Vulcan Materials Company
d/b/a Pleasanton Sand & Gravel
50 El Charro Road
Pleasanton, California 94588

**Subject: Eliot Quarry SMP-23 Reclamation Plan Amendment Project
CA Mine ID 91-01-0009**

Dear Messrs. Jamieson and Torell:

My firm represents CEMEX Construction Materials Pacific, LLC. ("CEMEX") as the consulting Project Manager for the Eliot Quarry SMP-23 Reclamation Plan Amendment Project ("Project") in Alameda County. CEMEX most recently filed application to Alameda County for the Project in December 2016, and is preparing a revised application based on County comment and Zone 7 Water Agency input that is anticipated to be submitted to the County later this month. The purpose for our letter is to coordinate with you regarding the planning, design and future construction of water conveyance facilities between Lakes A, B, and C to facilitate the chain-of-lakes concept described in the 1981 LAVQAR Specific Plan and the CEMEX SMP-23 and Vulcan SMP-16 reclamation plan entitlements.

CEMEX is required to coordinate with you based on Condition of Approval No. 7 of the SMP-23 Reclamation Plan entitlement (Alameda County Planning Commission Resolution No. 12-20, approved December 17, 2012), which reads in pertinent part:

"Permittee shall file an application to amend SMP-23, for review in accordance with ACSMO, Article II (Application Procedure), within six months of this action and which addresses the following issues and provides for their resolution, as well as any other issues applicant desires to address:

“(f) The need to coordinate the planning, design, and construction of all water conveyance structures between Lakes A, B, and C with adjacent mine operator, property owners and the Zone 7 Water Agency.” (emphasis added)

Under the proposed Project, CEMEX proposes to amend its SMP-23 Reclamation Plan with a Revised Reclamation Plan that reflects the water conveyance structures between Lakes A, B, and C while also achieving current surface mining reclamation standards for the remainder of the site. The planned post-mining end uses will continue to be water management, open space, and agriculture (non-prime).

As pertains to the water conveyance structures described in Condition of Approval No. 7, CEMEX is proposing the following as it relates to your properties:

- 1. Installation of a water conveyance pipeline from Lake A to future Lake C.** Conduits will be constructed between Lake A and future Lake C and Lake B and future Lake C, consistent with the original SMP-23. The pipeline from Lake A to Lake C will be 84-inch diameter to provide a conveyance capacity of 500 cfs. The conduit to Lake C will be stubbed and capped at CEMEX's property line until such time that future Lake C is developed on your properties. After the pipeline is constructed, the 500-cfs design discharge capacity will be verified by desktop analysis using as-built dimensions. Field testing may not be possible at the time of construction because water cannot be run through the pipeline until your excavations at future Lake C are complete. The pipeline will be operated by Zone 7 in the future. See Detail 1, below, from our draft Revised Reclamation Plan Sheet R-4.
- 2. Installation of a water conveyance pipeline between Lake B and future Lake C.** A conduit will be constructed between Lake B and future Lake C, consistent with the original SMP-23. The embankment between Lake B and future Lake C is natural and will not be mined or reconstructed. The Lake B to Lake C conduit will be a 30-inch-diameter pipe placed at an invert elevation of 349 feet msl that allows gravity flow between the two lakes. Mechanical pumping facilities will not be installed. Slides gates will be installed to control the transfer of water from one lake to another. Depending on the head difference between the two lakes, water may flow from Lake B to Lake C or from Lake C to Lake B when the control gates are open. However, until future Lake C is constructed, the conduit will require stub and cap at CEMEX's property line and may require the installation of a temporary blind flange at the invert end of the pipe in Lake B. A damage-resistant marker detectable by metal detectors will be placed at the surface of the stub and cap location to demarcate the location of the pipe. The pipe conduit will be operated by Zone 7 in the future. See Detail 2a and 2b, below, excerpted from our draft Revised Reclamation Plan Sheet R-4.

Page 3

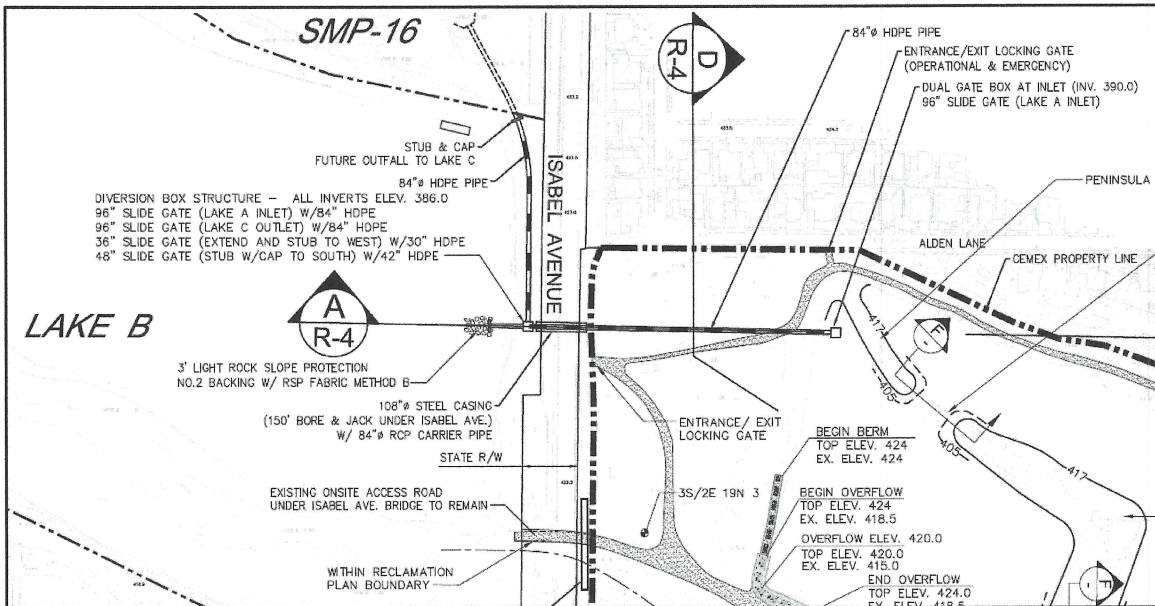

Detail 1. Water conveyance pipeline from Lake A to future Lake C

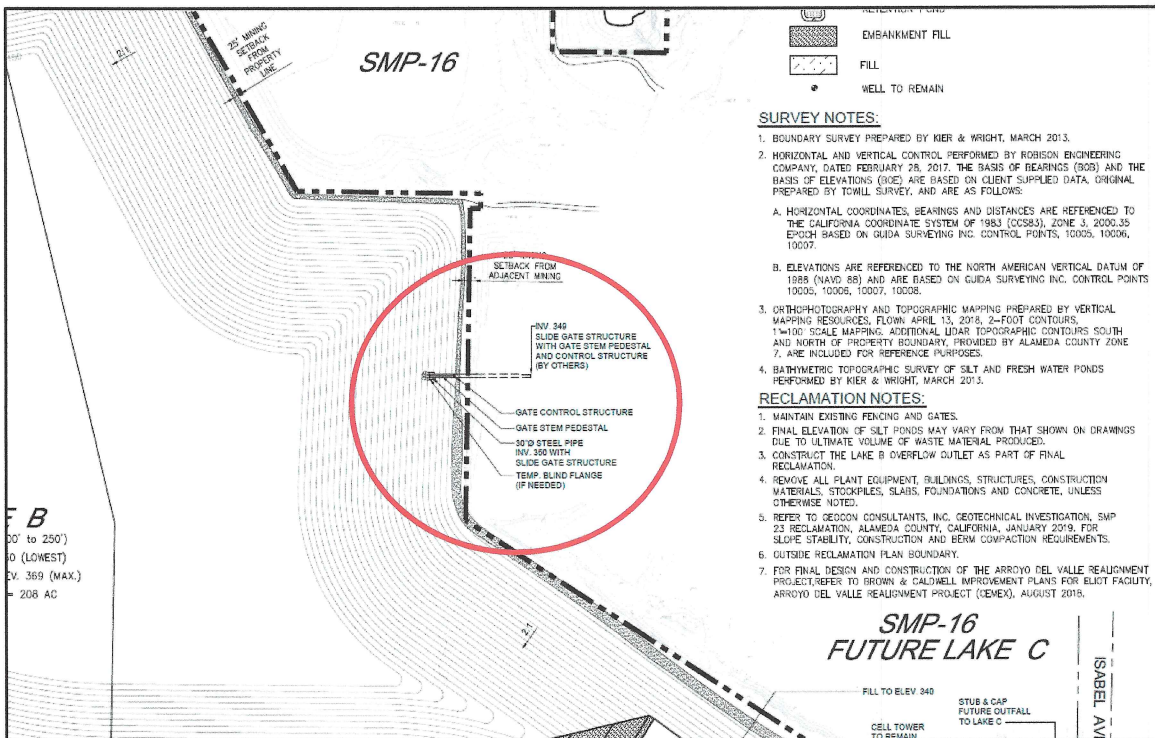

Detail 2a. Water conveyance pipeline between Lake B and future Lake C

Mr. Doug Jamieson
Mr. Kevin Torell
February 4, 2019
Page 4

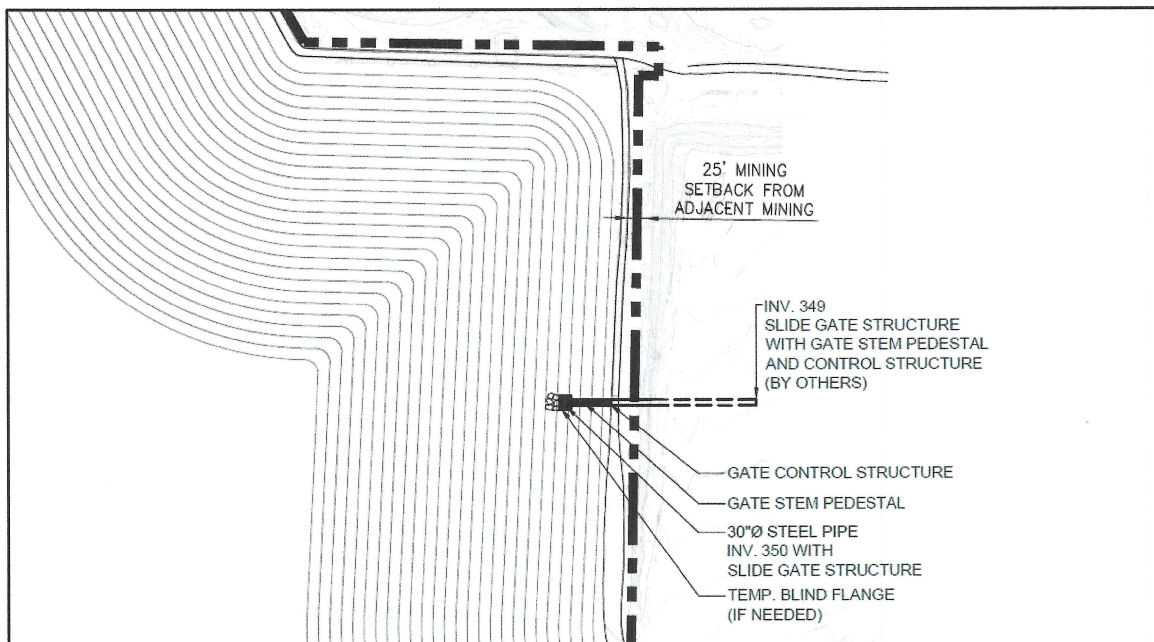

Detail 2b. Water conveyance pipeline between Lake B and future Lake C [Blow Up]

As described in our unapproved proposed draft Revised Reclamation Plan for the Eliot Quarry, CEMEX anticipates completing construction of the Lake A to C pipeline with a stub-and-cap at CEMEX's property line in year 2022, and the Lake B to C conduit with a stub-and-cap at CEMEX's property line in year 2031. More thorough coordination with you regarding the construction aspects of these water conveyance structures will need to occur in the future.

Should you have any questions, comments, or concerns, please contact either Debbie Haldeman (CEMEX) at 916-941-2844 or me at 916-825-4997 before February 22, 2019 (the anticipated filing date of our revised application).

Sincerely,

Yasha Saber
Compass Land Group
ysaber@compassand.net

Encl.

cc: Deborah Haldeman, CEMEX